

EXP-20SS.DWG

REVISION: C

ECO NO.: 1924-3

DRAWN BY: J. KNOSALLA

DATE: 7/07/03

COXREELS
SERIES T
STAINLESS STEEL

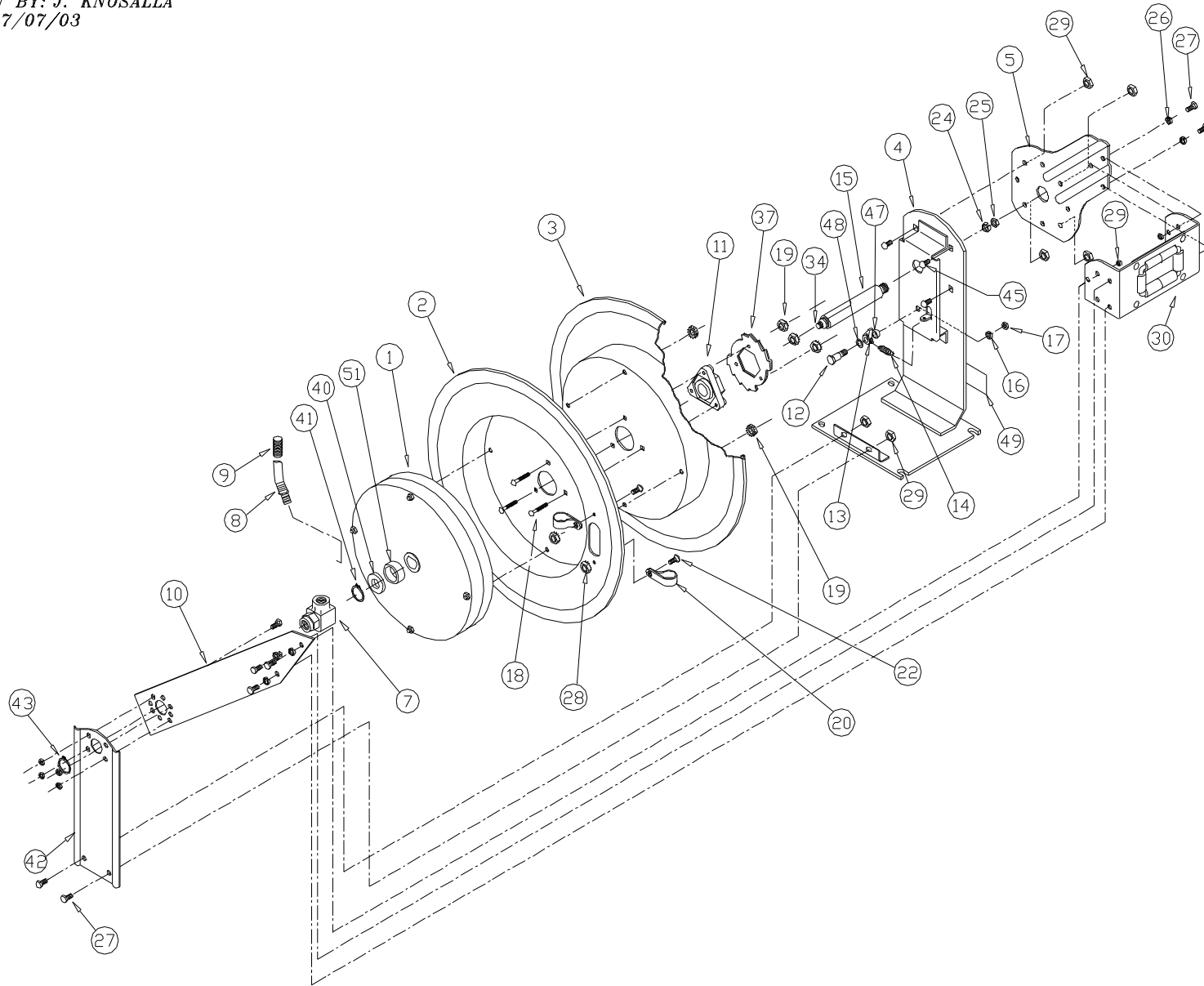

COMMON TO ALL SERIES T (STAINLESS STEEL) REELS

DETAIL ITEM NO.	PART NO.	DESCRIPTION	TSHL-N-450-SS	TSHL-N-550-SS	TSHL-N-4100-SS
1	692-1-SS	SPRING CAN, 15", SS	*	1	*
	656-SS	SPRING CAN, 15", SS	*	*	1
	691-3-SS	SPRING CAN, 12", SS	1	*	*
2	1703-SS	DISC, 19-1/2" X 2.25"W, W/SLOT, SS	1	*	*
	1705-SS	DISC, 24" X 2.25" W., W/SLOT, SS	*	1	1
3	1702-SS	DISC, 19-1/2" X 2.25"W., SS	1	*	*
	1704-SS	DISC, 24" X 2.25"W., SS	*	1	1
4	1784-SS	BASE, 19" T-REEL (ELECTRO-POLISH)	1	*	*
	1786-SS	BASE, 24" T-REEL (ELECTRO-POLISH)	*	1	1
5	1732-SS	ARM, GUIDE SS, 19" REEL (ELECTRO-POLISH)	1	*	*
	1733-SS	ARM, GUIDE SS, 24" REEL (ELECTRO-POLISH)	*	1	1
7	426-SS	SWIVEL, 3/4" NPT, CARBOXYLATED, SS	*	1	*
	434-SS	SWIVEL, 1/2" NPT, CARBOXYLATED, SS	1	*	1
10	1825-SS	ARM, GUIDE, SECONDARY, 24" REEL (ELECTRO-POL)	*	1	1
	1827-SS	ARM, GUIDE, SECONDARY, 19" REEL (ELECTRO-POL)	1	*	*
11	1776-5	BEARING, HUB, 1" ID	1	1	1
12	1620-SS	BOLT, SHOULDER, 1/2"X1-1/2"SS	1	1	1
13	640-1-SS	LOCKING DOG, F7 REEL, SS (PRESS	1	1	1
14	274-1-SS	SPRING, TENSION, LOCKING DOG	1	1	1
15	1794-SS	AXLE, 1" OD, 1-1/2" SPRING CAN, SS	1	1	1
16	437-SS	WASHER, LOCK, 3/8 SS	1	1	1
17	435-SS	NUT, HEX, LOCK, 3/8-16, SS	1	1	1
18	1953-SS	BOLT, CARRIAGE, 1/4-20 X 1-1/2", GR 5, SS	3	3	3
	125-SS	NUT, KEPS, 1/4-20	7	*	*
19	1777-SS	NUT, FLEX-LOCK, 1/4-20, SS	*	7	7
	382-SS	CLAMP, HOSE, #14, SS	2	*	2
20	384-SS	CLAMP, HOSE, #18, SS	*	2	*
	245-SS	SCREW, 10-32 X 3/8, TRUSS/PHP, SS	2	2	2
24	438-SS	WASHER, LOCK, 5/8", SS	1	1	1
25	3584-SS	NUT, HEX, 5/8-11, SS	1	1	1
26	112-SS	WASHER, LOCK, 5/16", SS	6	6	6
27	312-SS	BOLT, HEX, 5/16-18 X 3/4", SS	12	12	12
28	130-SS	NUT, KEPS, 10-32, SS	2	2	2
29	111-SS	NUT, LOCK, 5/16-18, SS NYLON ELEM	16	16	16
30	1829-1-SS	ROLLER BRACKET, T-REEL, SS (ASSY)	1	1	1
34	10235-SS	STUD, SS, 3/8-16 UNC-2A X 1	1	1	1
37	1924-SS	LOCKING RING, SS, F7 REEL	1	1	1
40	1755-1	WASHER, SPACER, HDPE, BLACK	1	1	1
41	1753-SS	RETAINING RING, SS (5160-75HSTB)	1	1	1
42	1712-SS	POST, SUPPORT, 3/4" SWVL, 24" REEL	*	1	*
	1740-SS	POST, SUPPORT, 3/8"-1/2" SWVL, 19" REEL	1	*	*
	1741-SS	POST, SUPPORT, 3/8"-1/2" SWVL, 24" REEL	*	*	1
43	1754-SS	RETAINING RING, SS (5100-112H)	1	*	1
	516-SS	RETAINING RING, SS (5100-137)	*	1	*
45	10220-75-SS	BOLT, CARRIAGE, 5/16-18 X 3/4", GR 5, SS	4	4	4
47	6440-SS	WASHER, SPACER, .286" W., SS	1	1	1
48	6441-1	SPACER, WASHER, HDPE BLACK	1	1	1
49	10925-5	LABEL	1	1	1
51	7511	SPACER, AXLE	1	*	*

REEL ASSEMBLY REPORTS: R101 (LATCHOUT REMOVAL), R101 (LOCKING RING PLACEMENT), R112 (TIGHTENING AND TORQUING)