

EXP-91

REVISION: B
ECO NO.: 1927-2
DRAWN BY: J. KNOSALLA
DATE: 7/22/03

COXREELS PC17 SERIES CORD REELS

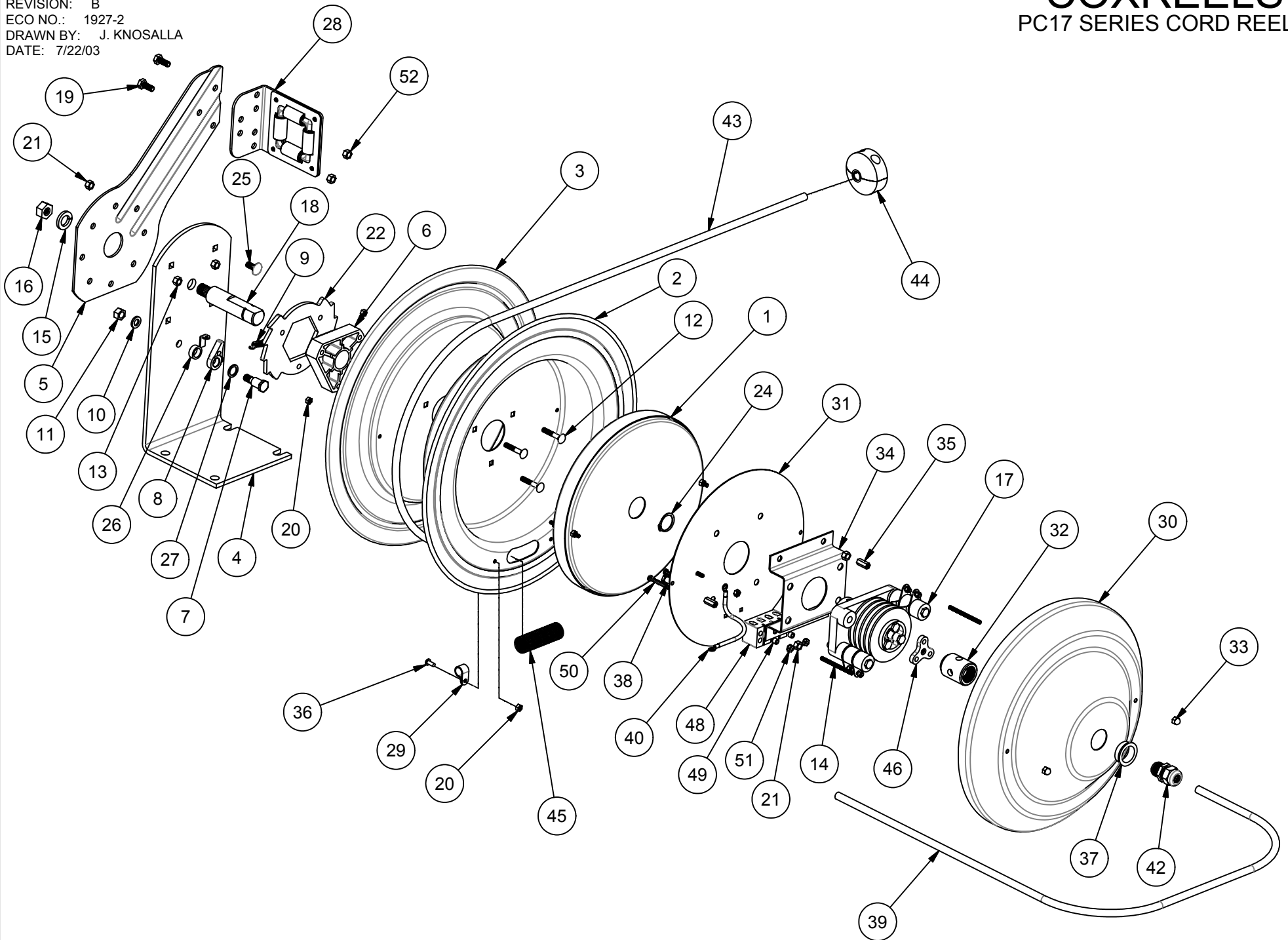

COMMON PARTS TO ALL PC17-SERIES ELECTRIC CORD REELS

ASSY. ITEM NO.	DETAIL ITEM NO.	PART NO.	DESCRIPTION	PC17-3510-X	PC17-5010-X	PC17L-5010	PC17-3510-4	PC17-5010-4	PC17L-5010-4				
	1	1961-5	SPRING CAN	1			1						
		2037-5	SPRING CAN		1	1		1	1				
	2	7193	DISC, 17" REEL, W/SLOT	1	1	1	1	1	1				
	3	1947	DISC, 17" REEL	1	1	1	1	1	1				
	4	1970	BASE, 17" REEL	1	1	1	1	1	1				
	5	1732-2	ARM GUIDE, 17"	1	1	1	1	1	1				
	6	1776-3	ASSY, HUB BEARING, 1"	1	1	1	1	1	1				
	7	1620	BOLT, SHOULDER, ½"x1½"	1	1	1	1	1	1				
	8	640-1-SS	CAM, LOCKING	1	1	1	1	1	1				
	9	274-1-SS	SPRING, DOG	1	1	1	1	1	1				
	10	437	WASHER, LOCK, 3/8"	1	1	1	1	1	1				
	11	184	NUT, JAM. 3/8-16	1	1	1	1	1	1				
	12	1953	BOLT, CARRIAGE, ¼-20 x 1½"	3	3	3	3	3	3				
	13	125	NUT, KEPS, ¼-20	3	3	3	3	3	3				
	14	7197	STUD, THREADED, 10-32 x 3"	2	2	2	2	2	2				
	15	438	WASHER, LOCK, 5/8"	1	1	1	1	1	1				
	16	3584	NUT, 5/8-11	1	1	1	1	1	1				
	17	7157	ASSY., SLIP RING, 35A	1	1	1	1	1	1				
	18	7159	AXLE, 1"	1	1	1	1	1	1				
	19	312	BOLT, 5/16-18	3	3	3	3	3	3				
	20	130	NUT, KEPS, 10-32	5	5	5	5	5	5				
	21	111-1	NUT, LOCK, 5/16-18, LOW PROF	8	8	8	8	8	8				
	22	1924	RING, LOCKING	1	1	1	1	1	1				
	24	206	RING, RETAINING, (5100-100)	1	1	1	1	1	1				
	25	10220-75	BOLT, CARRIAGE, 5/16-18 x ¾"	4	4	4	4	4	4				
	26	6440-SS	WASHER, SPACER	1	1	1	1	1	1				
	27	6441-1	WASHER, PLASTIC	1	1	1	1	1	1				
	28	1728-3	BRACKET, ROLLER, 17"	1	1	1	1	1	1				
	29	115	CLAMP, CABLE	2	2	2	2	2	2				
	30	7180	COVER, 17", 10GA	1	1	1	1	1	1				
	31	7190	ELECTRICAL MOUNTING PLATE	1	1	1	1	1	1				
	32A	7184	INLET, PORT, 1/2-14 NPT	1	1	1							
	32B	7184-1	INLET, PORT, 3/4-14 NPT				1	1	1				
	33	7196	NUT, ACORN, 10-32	2	2	2	2	2	2				
	34	7189	BRACKET, SLIP RING	1	1	1	1	1	1				
	35	7163	NUT, COUPLING, 10-32 x ¾"	2	2	2	2	2	2				
	36	245	SCREW, TRUSS HEAD, 10-32x3/8"	2	2	2	2	2	2				
	37	7167-1	BUSHING, OPEN, PLASTIC	1	1	1							
	38	175	BOLT, HEX, 5/16-18 x ½"	4	4	4	4	4	4				
	39A	7172-10	CABLE, 3 WIRE, 10GA	5FT	5FT								
	39B	7173-10	CABLE, 4 WIRE, 10GA				5FT	5FT					
	40	7185	ASSY., WIRE, JUMPER, 10GA	1	1	1	1	1	1				
	41	7176-3	NUT, WIRE, RED	3	3		4	4					
	42A	7168-3	STRAIN RELIEF, INPUT, 10GA	1	1	1							
	42B	7168-4	STRAIN RELIEF, INPUT, 10GA				1	1	1				
	43A	7172-10	CABLE, 3 WIRE, 10GA, SO	36FT.	51FT.								
	43B	7173-10	CABLE, 4 WIRE, 10GA, SO				36FT.	51FT.					
	44	131-3	ASSY., STOP,	1	1		1	1					
	45	237-1	GUARD, CABLE, SPRING	1	1		1	1					
	46	7170	BRACKET, INLET PORT	1	1	1	1	1	1				
	47	7175-2	TERMINAL, RING, 12-10GA / #10	3	3		4	4					
	48	8284	TERMINAL BLOCK			1			1				
	49	8286	SPACER, NYLON			2			2				
	50	8285	SCREW, 8-32 X 1-1/4" LG			2			2				
	51	10137	NUT, KEPS, 8-32			2			2				
	52	111	NUT, LOCK, 5/16-18	3	3	3	3	3	3				