

# EXP-90EZ

REVISION: D  
ECO NO.: 2371-8  
BY: M. LLOYD  
DATE: 01/04/07

# COXREELS SERIES EZ-PC13

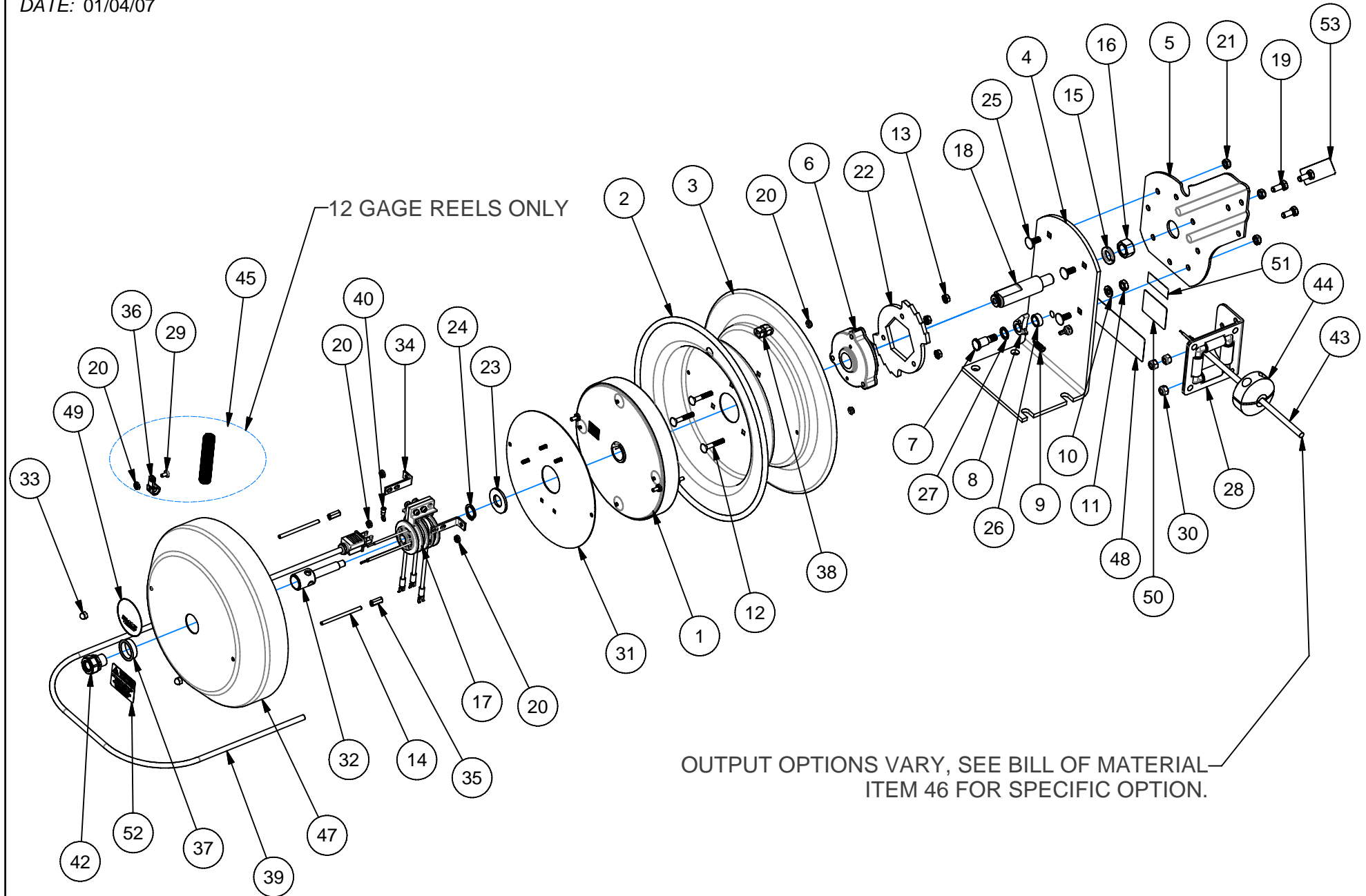

ITEM	PART	DESCRIPTION	QTY
3	140-1	DISK: 13" REEL	1
4	1954	BASE: 13" REEL	1
5	1732-1	ARM: GUIDE, 13"	1
7	1620	BOLT: 1/2" X 1-1/2" SHOULDER	1
8	640-1-SS	CAM: LOCKING	1
9	274-1-SS	SPRING: LOCK DOG	1
10	437	WASHER: 3/8" LOCK	1
11	184	NUT: 3/8-16 JAM	1
12	1953	BOLT: 1/4-20 X 1-1/2" CARRIAGE	3
13	125	NUT: 1/4-20 KEPS	3
14	7197	STUD: THREADED, 10-32 X 3"	2
15	438	WASHER: 5/8" LOCK	1
16	3584	NUT: 5/8-11 HEX	1
18	1956	AXLE: 1"	1
19	312	BOLT: 5/16-18	3
20	130	NUT: #10-32 KEPS, QTY. = 7 IF 12-GAGE	5
21	111-1	NUT: 5/16-18 NYLOCK (LOW PROFILE)	4
22	1924	RING: LOCKING	1
23	1755-1	WASHER: SPACER	1

ITEM	PART	DESCRIPTION	QTY
24	1753	RING: RETAINING (5160-75)	1
25	10220-75	BOLT: 5/16-18 x 3/4" CARRIAGE	4
26	6440-SS	WASHER: SPACER	1
27	6441-1	WASHER: PLASTIC	1
28	1728-2	ASSEMBLY: ROLLER BRACKET	1
30	111	NUT: 5/16-18 NYLOCK	3
31	7166	PLATE: ELECTRICAL MOUNTING	1
32	7161	PORT: INLET	1
33	7196	NUT: #10-32 ACORN	2
34	7160	SUPPORT: BRUSH CONTACT	2
35	7163	NUT: #10-32 X 3/4" COUPLING	2
37	7167-1	BUSHING: OPEN, PLASTIC	1
47	7162	COVER: 13"	1
48	10925-5B	LABEL: PRODUCT, EZ-COIL	1
49	10937	LABEL: EZ-COIL	1
50	10935	LABEL: CORD SPECS., PC REELS	1
51	10937-1	LABEL: EZ-COIL PATENT	1
52	10934	LABEL: CAUTION, PC REELS	1
53	10950	LABEL: EZ-COIL ARM	1

ITEM NUMBER

MODEL	ITEM NUMBER															46	
	1	2	6	17	29	36	38	39	40	41	42	43	44	45	ACCESSORY ITEM		
	SPRING	DISK	EZ-COIL	SLIP RING	SCREW (2)	CLAMP (2)	BUSHING 90°	INPUT CABLE	TERM RING	WIRE NUT (5)	STRAIN RELIEF	CABLE (FT)	STOP	CBL GUARD			
EZ-PC13-3516-D	1960-1	7191	7474-4-R	7155	-	-	7169-2	7198	7175-1	7176-1	7168-1	-	131-1	-	7207-1	ANGLE LIGHT, FLUORESCENT, 35'	
EZ-PC13-5016-A	1960	7191	7474-4-R	7155	-	-	7169-2	7198	7175-1	7176-1	7168-1	-	131-1	-	7188-2	RECEPTICAL, SINGLE, MOLDED, 50'	
EZ-PC13-5016-C	1960	7191	7474-4-R	7155	-	-	7169-2	7247	7175-1	7176-1	7168-1	-	131-1	-	7208-2	TUBE LIGHT, FLUORESCENT, 50'	
EZ-PC13-5016-D	1960	7191	7474-4-R	7155	-	-	7169-2	7198	7175-1	7176-1	7168-1	-	131-1	-	7207-2	ANGLE LIGHT, FLUORESCENT, 50'	
EZ-PC13-5016-E	1960	7191	7474-4-R	7155	-	-	7169-2	7198	7175-1	7176-1	7168-1	-	131-1	-	7206-2	CAGED LIGHT, INCANDESCENT, 50'	
EZ-PC13-5012-A	1960	7192	7474-3-R	7155	245	7199	-	7174-2	7175-2 (4)	7176-2	7168-2	7172-12	131	237-2	7215-2	RECEPTICAL, SINGLE, 20 AMP	
EZ-PC13-5012-B	1960	7192	7474-3-R	7155	245	7199	-	7174-2	7175-2 (4)	7176-2	7168-2	7172-12	131	237-2	7203-2	RECEPTICAL, QUAD BOX, 20 AMP	
EZ-PC13-5012-F	1960	7192	7474-3-R	7155	245	7199	-	7174-2	7175-2 (4)	7176-2	7168-2	7172-12	131	237-2	7205-2	RECEPTICAL, DUPLEX GFCI, 20 AMP	
EZ-PC13-5012-X	1960	7192	7474-3-R	7155	245	7199	-	7174-2	7175-2	7176-2	7168-2	7172-12	131	237-2	-	-	
EZ-PC13-5012-4	1960	7192	7474-3-R	7155	245	7199	-	7173-12	7175-2	7176-2	7168-3	7173-12	131	237-2	-	-	

ACCESSORIES

A - SINGLE IND. RECEPTICAL B - QUAD BOX IND. RECEPTICAL C - FLUORESCENT TUBE LIGHT D - FLUORESCENT ANGLE LIGHT E - CAGED INCANDESCENT LIGHT F - DUPLEX RECEPTICAL, GFCI X - NONE 4 - FOUR WIRE CABLE READY

REEL ASSEMBLY REPORTS:

R100 (LATCHOUT REMOVAL), R101 (LOCKING RING PLACEMENT), R112 (TIGHTENING AND TORQUING)

OPERATING INST #028 (CORD INSTALLATION PROCEDURE)

REVISION: D

ECO: 2371-8

DATE: 1/4/2007

NAME: M. LLOYD