

SPRING DRIVEN WELDING CABLE REELS **P-WC SERIES**

COXREELS® P-WC Series spring driven "Welding Cable" reels protect and extend the life of your welding cable by neatly and conveniently storing it on a 25, 35 or 50 foot self-retracting welding cable reel. They are the solution for keeping your work area safe, organized and efficient.

WELDING CABLE REEL

Protect & extend the life of your welding cable while keeping your work area and vehicles clean & organized. **Caution: When using reel for extended periods of time unwind all cable to prevent heat build up.**

| CABLE | | | | | | LESS CABLE | | SIZE INDEX |
|--------------------|-----|------|-------|-------|------------|---------------------|------------|------------|
| MODEL | FT. | TYPE | VOLT. | AMPS. | APRX. LBS. | MODEL | APRX. LBS. | |
| P-WC13-3506 | 35 | 6ga | 600 | 75 | 31 | P-WC13L-3506 | 26 | 1 |
| P-WC13-5006 | 50 | 6ga | 600 | 75 | 35 | P-WC13L-5006 | 28 | 1 |
| P-WC13-3504 | 35 | 4ga | 600 | 150 | 34 | P-WC13L-3504 | 26 | 1 |
| P-WC13-5004 | 50 | 4ga | 600 | 150 | 39 | P-WC13L-5004 | 28 | 1 |
| P-WC13-3502 | 35 | 2ga | 600 | 225 | 36 | P-WC13L-3502 | 26 | 1 |
| P-WC17-5002 | 50 | 2ga | 600 | 225 | 56 | P-WC17L-5002 | 42 | 2 |
| P-WC13-2501 | 25 | 1ga | 600 | 300 | 35 | P-WC13L-2501 | 26 | 1 |
| P-WC17-5001 | 50 | 1ga | 600 | 300 | 60 | P-WC17L-5001 | 42 | 2 |
| P-WC13-2510 | 25 | 1/0 | 600 | 350 | 37 | P-WC13L-2510 | 26 | 1 |
| P-WC17-5010 | 50 | 1/0 | 600 | 350 | 64 | P-WC17L-5010 | 42 | 2 |
| P-WC17-3520 | 35 | 2/0 | 600 | 450 | 60 | P-WC17L-3520 | 42 | 2 |
| P-WC17-5020 | 50 | 2/0 | 600 | 450 | 68 | P-WC17L-5020 | 42 | 2 |



P-WC SERIES :: REEL SPECIFICATIONS

SLIP RING

- External, easily accessible heavy gauge CPC™ powder coated steel components cover for simple slip ring routine maintenance
- Electrical current runs through a 450 AMP rated slip ring

DESIGN & STRUCTURE

- Designed for electrode & grounding lead applications (each lead requires an individual reel)
- Single pedestal reel with space saving design facilitates workplace organization
- Welding cable clamp available (see below)
- Guide arm adjusts to wall, floor, vehicle & overhead positions
- Solid one piece, heavy gauge 1/4" steel base & support post for maximum stability
- 1" solid steel axle & lubricated precision bearings for smooth rotation

RETRACTION

- Enclosed factory tuned & matched cartridge-style spring motor
- Non corrosive stainless steel spring, pawl & zinc plated ratchet
- Multi-position lock ratchet mechanism secures cable at desired length

SIGNATURE FEATURES

- Professional grade heavy duty steel construction
- Durable proprietary CPC™ powder coat process
- Rolled edges & ribbed discs provide strength & safety
- Leading 2-year manufacturer's limited warranty
- Made in the U.S.A. - Sold & Supported Worldwide

POSSIBLE FIELDS OF APPLICATION

- Manufacturing Plants & Facilities
- Maintenance, Repair & Operations
- Welding / Service Trucks
- Welding Shops
- Garage Settings
- Automotive & Fleet Maintenance
- Pipelines
- Mining, Construction & Railroad Operations
- Marine/Ship Building/ Offshore

ACCESSORIZE YOUR REEL :: PG 50

- Mounting Brackets
- Assorted Reel Accessories

REEL DIMENSIONS

Technical Data Sheets Available On Website

| SIZE INDEX | W | H | L | X | Y | M | N |
|------------|--------|---------|---------|----|----|----|----|
| 1 | 8 1/2" | 14 1/2" | 13 3/4" | 5" | 6" | 3" | 5" |
| 2 | 11" | 18 1/4" | 17 1/4" | 6" | 6" | 4" | 5" |

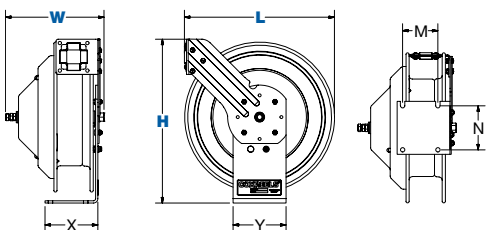

COXREELS® ACCESSORY

| | | | |
|---|---|---|--|
|  | <p>Electrode Holder</p> <p>Electrode holder features a six-position jaw pattern and has fully insulated, protected springs. # 7685</p> |  | <p>Grounding Clamp</p> <p>300 Amp with solid copper jaws & fits cable ballpoint thru 3/0. #7688</p> |
|---|---|---|--|

